

REAR SHOCK ABSORBER (w/ REAS)

COMPONENTS

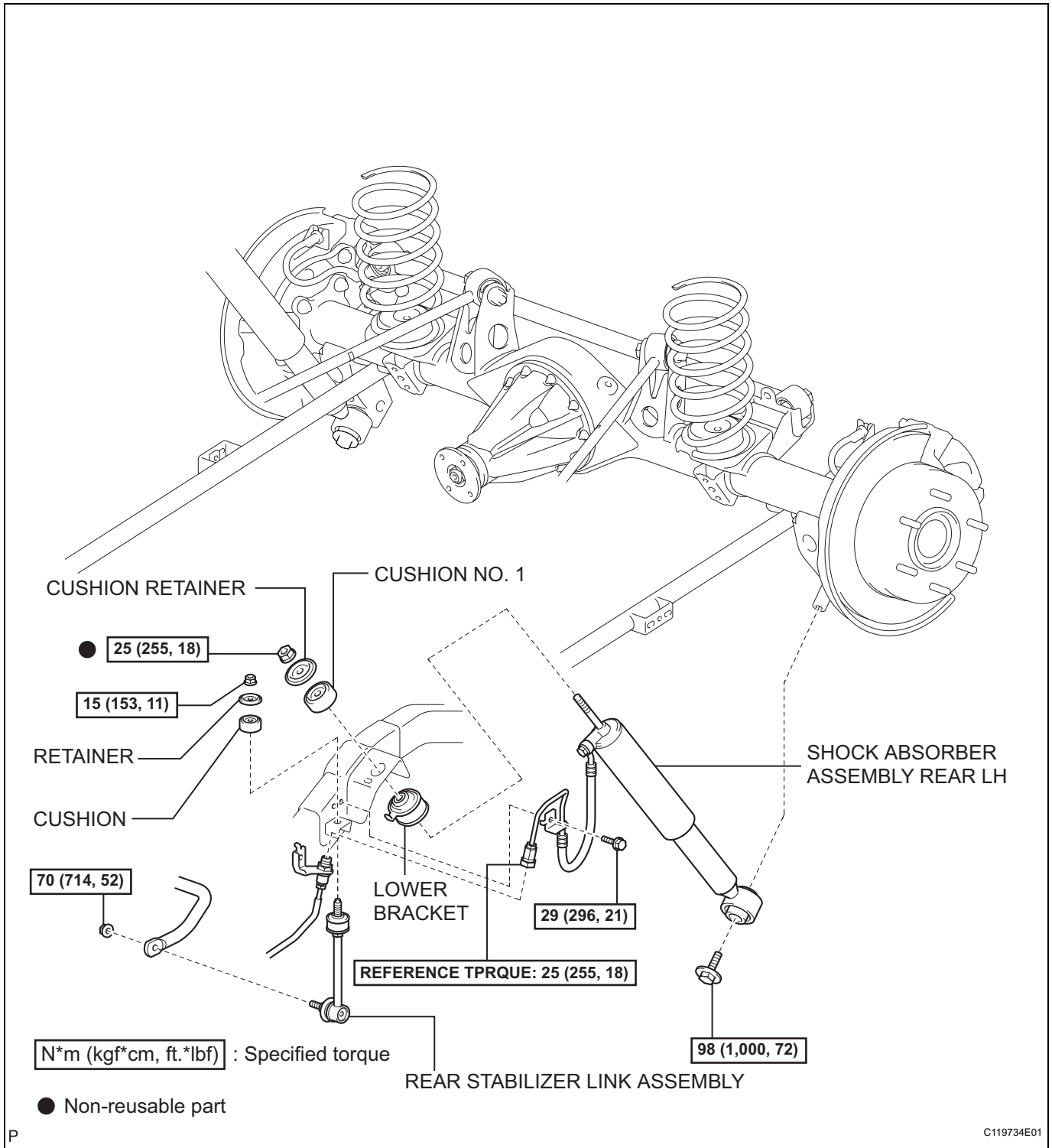

SP

REMOVAL

NOTICE:

Be sure to read **PRECAUTIONS** before performing this procedure (See page [SC-1](#)).

1. REMOVE REAR WHEEL
2. REMOVE REAR STABILIZER LINK ASSEMBLY (See page [SP-53](#))
3. REMOVE SHOCK ABSORBER ASSEMBLY REAR LH
 - (a) Remove the bolt and disconnect the bracket.

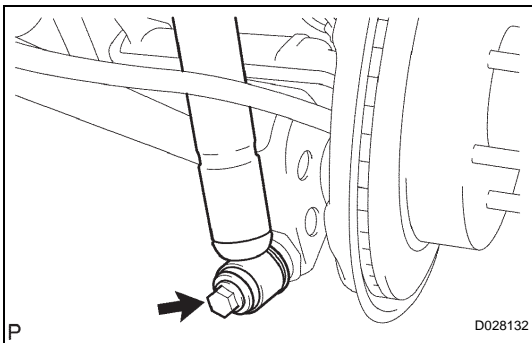
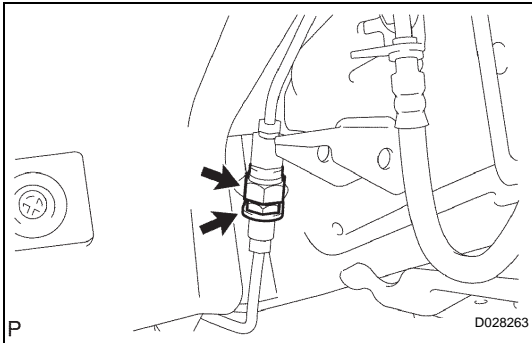
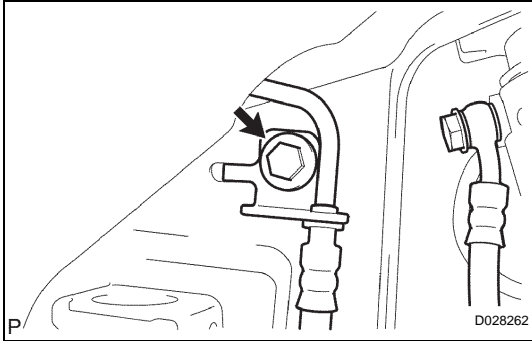

- (b) Using a wrench to hold the bracket, remove the joint.

NOTICE:

Check that all shock absorbers are fully extended to the normal suspension rebound point.

- (c) Remove the bolt and disconnect the shock absorber assembly rear LH from the rear axle housing.

NOTICE:

Ensure that the rear axle housing is supported so that the shock absorber assembly rear LH is not extended beyond the normal suspension rebound point.

- (d) Remove the nut, cushion retainer, cushion No.1 and shock absorber assembly rear LH.

NOTICE:

- Remove the shock absorber assembly rear LH with the shock absorber rod fully extended.
- Be sure to hold the body part of the shock absorber assembly rear LH when carrying it.

- (e) Remove the lower bracket from the shock absorber assembly rear LH.