

# REAR COIL SPRING

## COMPONENTS

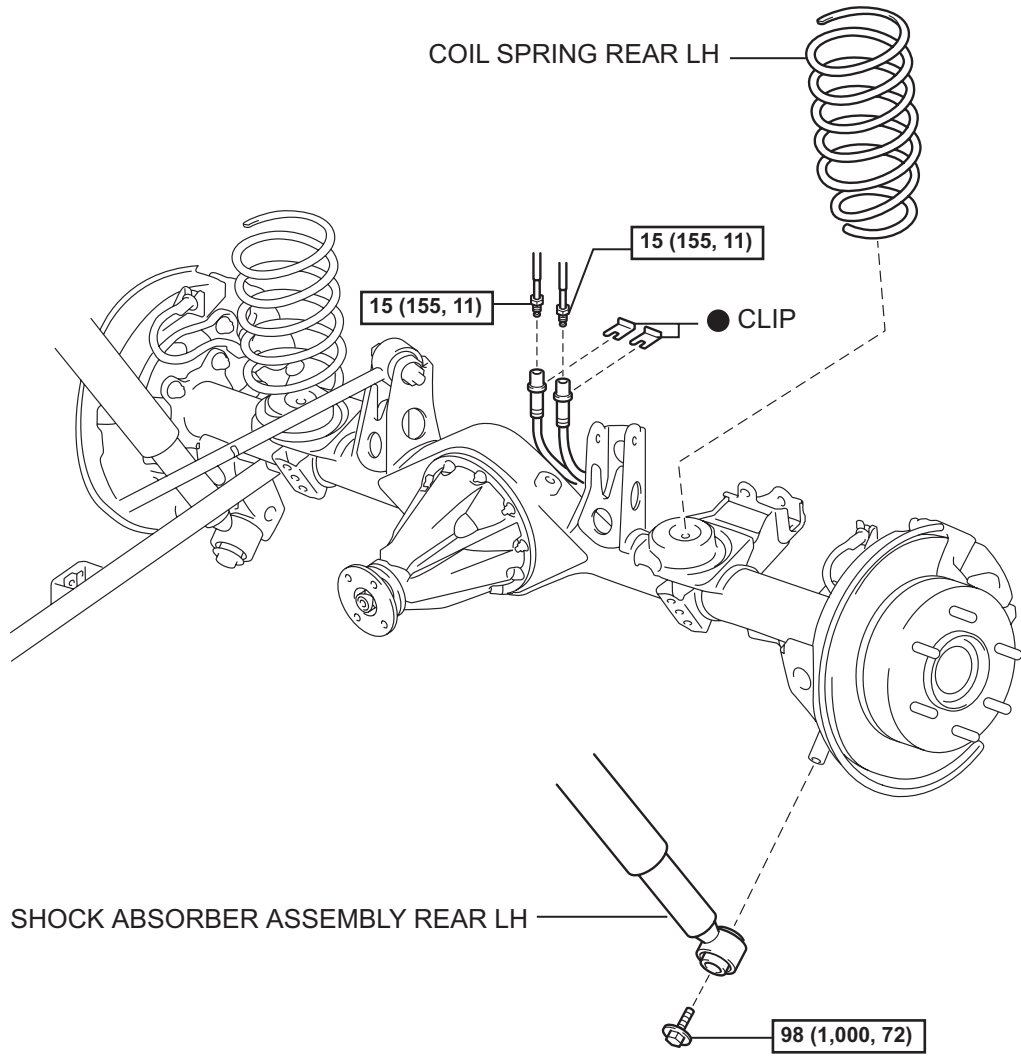

SP

**N\*m (kgf\*cm, ft.\*lbf)** : Specified torque

● Non-reusable part

## REMOVAL

1. REMOVE REAR WHEEL
2. SEPARATE SHOCK ABSORBER ASSEMBLY REAR LH

- (a) Support the rear axle housing.
- (b) Remove the bolt, separate the shock absorber assembly rear LH from the rear axle.

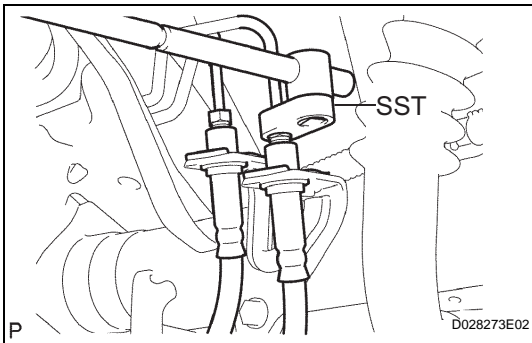
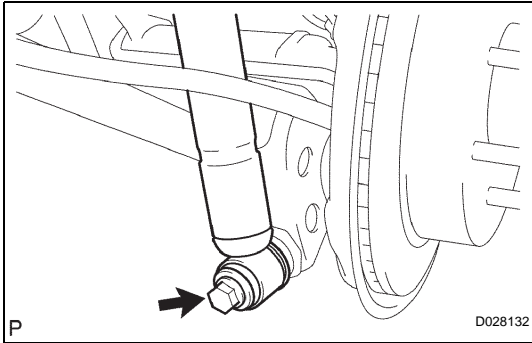

3. DISCONNECT REAR BRAKE TUBE FLEXIBLE HOSE

- (a) Using SST, disconnect the 2 rear brake tubes from each of the flexible hoses. Use a container to catch brake fluid as it drains out.

**SST 09023-00101**

- (b) Remove the 2 clips and disconnect the 2 flexible hoses.

4. REMOVE COIL SPRING REAR LH

- (a) Start to lower the rear axle housing.

**NOTICE:**

**Be careful not to snap the brake line and parking brake cable.**

- (b) While lowering the rear axle housing, remove the coil spring rear LH.

## INSTALLATION

1. INSTALL COIL SPRING REAR LH

- (a) Install the coil spring rear LH to the rear axle housing.

**HINT:**

Fit the lower end of the coil spring into the gap of the spring lower seat

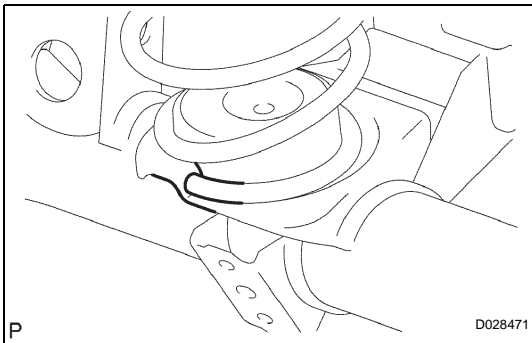

2. CONNECT SHOCK ABSORBER ASSEMBLY REAR LH

- (a) Install the shock absorber, temporarily tighten the bolt.

3. STABILIZE SUSPENSION (See page [SP-39](#))

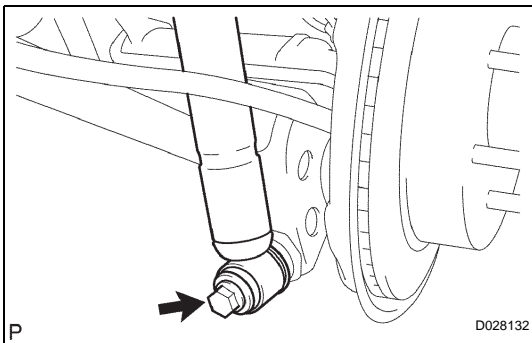

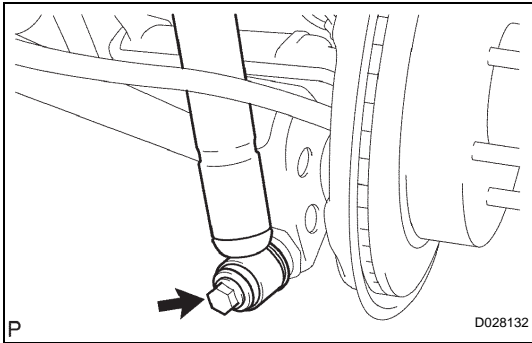

**4. FULLY TIGHTEN SHOCK ABSORBER ASSEMBLY REAR LH**

- (a) Fully tighten the bolt.  
**Torque: 98 N\*m (1,000 kgf\*cm, 72 ft.\*lbf)**

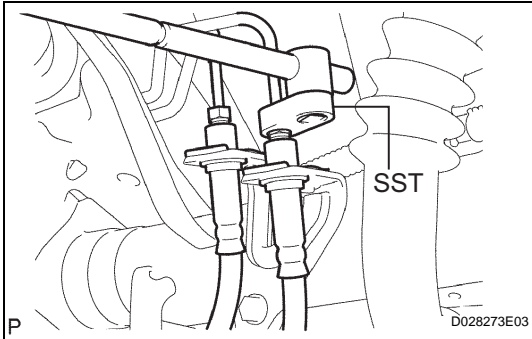

**5. CONNECT REAR BRAKE TUBE FLEXIBLE HOSE**

- (a) Install the 2 clips with the 2 flexible hoses.  
 (b) Using SST, connect the brake tubes to the flexible hose.

**Torque: 15 N\*m (155 kgf\*cm, 11 ft.\*lbf)**  
**SST 09023-00101**

**6. FILL RESERVOIR WITH BRAKE FLUID**

**7. BLEED BRAKE LINE**

**8. CHECK FLUID LEVEL IN RESERVOIR**

**9. CHECK BRAKE FLUID LEAKAGE**

**10. INSTALL REAR WHEEL**

**Torque: 112 N\*m (1,137 kgf\*cm, 83 ft.\*lbf)**